

OMAR HERITAGE PARK HOME



# HERITAGE



## Key Features

- Large feature dormer with CanExel Herringbone detail, corner quoins and fluted columns
- Feature composite front door with glazed side panels, French doors to the dining area and curved Bay windows with Georgian bar
- Luxury fitted kitchen with range cooker, American fridge-freezer, pull-out larder units, Silestone worktop and ceramic Belfast sink
- Bedrooms with free-standing, contemporary, French style furniture (dressing area and luxury en-suite to the master)
- Free-standing bath with floor-mounted waterfall tap and designer radiator to the bathroom
- Study and utility room

## Example Floor Plan (50' x 22')

The Heritage is available in a range of standard floor plans which can be adapted to suit your individual needs.

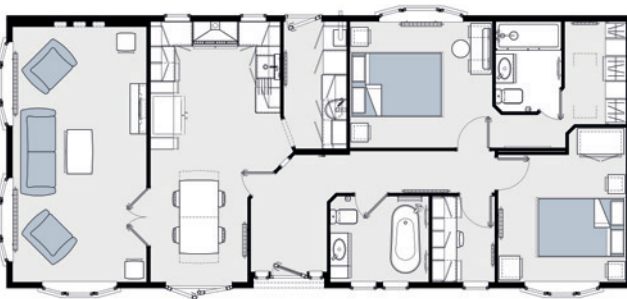

The minimum size for this model is 48' x 20' and the maximum size is 65' x 22'.

## Visit our showground

To see our park homes and lodges first-hand, book an appointment to visit us. We have showgrounds with a number of models available to view at both our Brandon, Suffolk and Hull manufacturing facilities.

**Please note:** Decking and props are not included, some photos may include optional extras and specifications and layouts may differ from those shown here. For full details, please contact our sales team.



LOUNGE



EN-SUITE



MASTER BEDROOM



DINING AREA



KITCHEN

Omar Park & Leisure Homes, Pleszko House, London Road, Brandon, Suffolk IP27 ONE

**01842 810 673 | [www.omar.co.uk](http://www.omar.co.uk) | [sales@omar.co.uk](mailto:sales@omar.co.uk)**

To see more scan this code

